

KTZ615-51

Kontroll-Nr. --

2019-05-22 V.01.02.2019

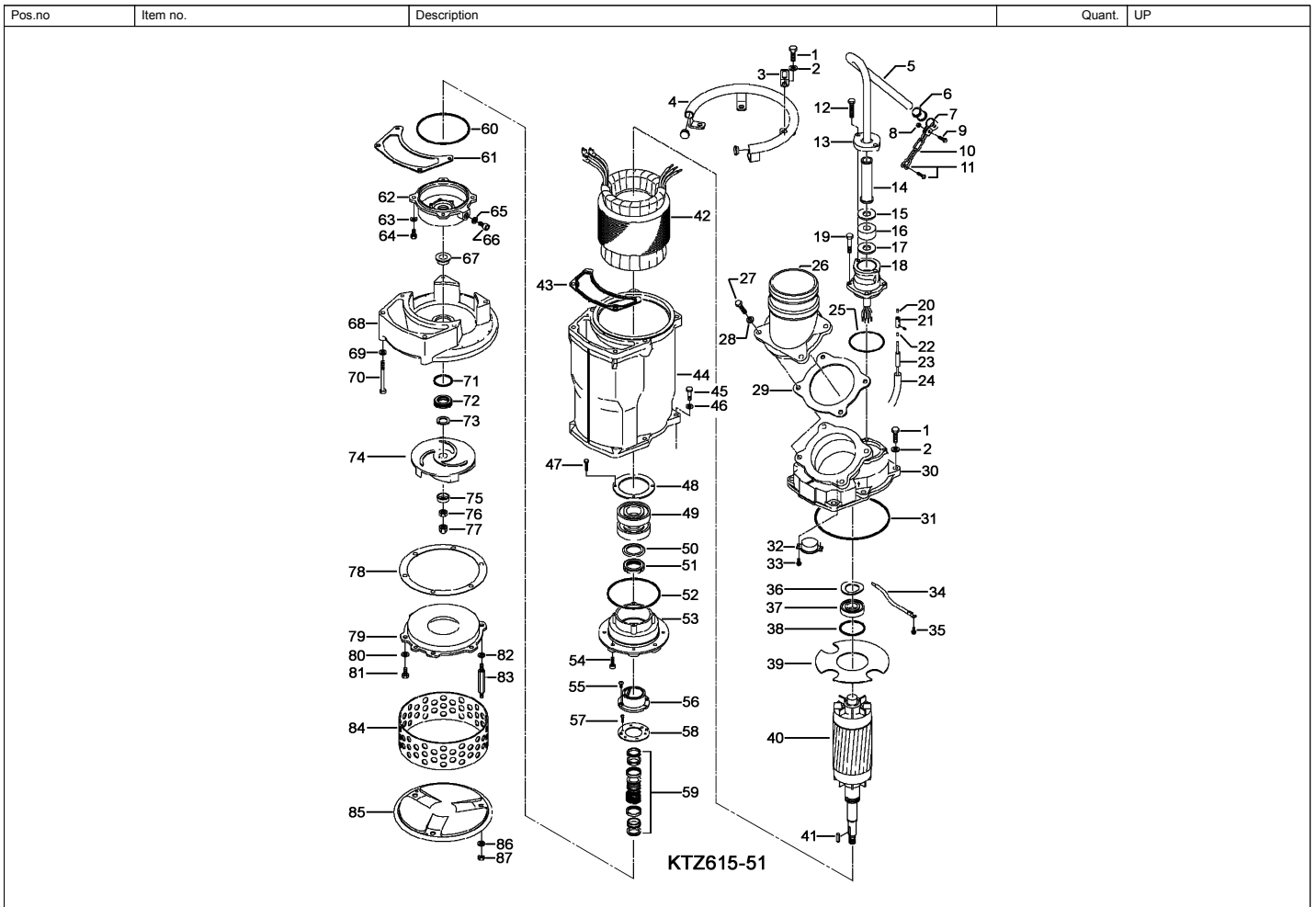

Pos.no	Item no.	Description	Quant.	UP
	173-000-86	Packing O-Ring Set (Marked by *)	1	
1	140-101-12	Hex.Bolt M12x50 SUS304 (EN X5CrNi18-10) Stainless Steel	6	
2	142-165-10	Spring Washer M12 SUS304	6	
3	070-117-11	L-Shape Fitting 40x25x4.5t d13Hole SPC	1	
4	068-000-32	Handle SGP+SS	1	Price on req.
5	M01-TEG-23	Cabletyre Cable Set (20m) NSSHÖU 4Cx6mm ²	1	
6	010-121-19	Cable Clip Rubber (EUR,NSU) No.1 NBR	1	
7	010-120-18	Cable Clip No.2-1 SPC	1	
8	141-004-59	Hex.Nut M6 SWRM	1	
9	140-032-37	Hex.Bolt M6x15 SWRM	1	
10	095-131-18	Chain 4mm(3L) SS	1	
11	011-101-19	Shackle 6mm SS	1	
12	140-076-17	Hex.Bolt M10x30 SUS304	2	
13	003-183-23	Gland GHZ-311W FC	1	
14	002-104-14	Cable Protection Tube 400/415V-50Hz(EUR) No.4 NBR	1	
15	005-122-17	Bush Washer 380V-50Hz d23xd53.5x3.2t SPC	1	
16	004-135-10	Cable Bush 400/415V-50Hz(EUR) d21xd54x25l SBR	1	
17	005-122-17	Bush Washer 380V-50Hz d23xd53.5x3.2t SPC	1	
18	006-160-10	Stuffing Box GHZ-311W FC	1	
19	140-055-10	Hex.Bolt M8x25 SUS304	4	
20	009-129-16	Terminal E (Small) CU	4	
21	009-101-12	Terminal(C/W Screw) d12x(d6.6xd6.6)x25l C3604	4	
22	009-129-16	Terminal E (Small) CU	4	
23	002-135-14	Heat Shrink Tube (Sold per meter) A(d15x0.3t) (V/m)	1	
24	002-132-11	Heat Shrink Tube (Sold per meter) A4(d17x0.27t) (V/m)	1	
25	122-128-19	O-Ring G-85(84.4xd3.1) NBR	1	
26	032-001-02	Hose Coupling (for EUR,NSU) KTZ611-53(Angle,BSPT-6) FC	1	
27	140-099-16	Hex.Bolt M12x40 SUS304	4	
28	142-129-25	Plain Washer M12 SPC	4	
29	121-001-49	Packing (Hose Coupling) KTZ-11(Angle) NBR	1	Price on req.
30	050-001-13	Motor Bracket FC	1	
31	122-173-19	O-Ring V-225 NBR	1	
32	053-002-22	Motor Protector 220/230/240V-50Hz(EUR) 1 KA143-CCTL402 (H.C)	1	
33	143-125-24	Pan Screw (w/Spring Washer/Plain Washer) M4x14 SWRM	2	
34	009-296-15	Earth Terminal 8mm2x180L	1	
35	143-164-25	Pan Screw (w/Spring Washer) M6x8 BSBM	1	
36	142-198-12	Wave Washer 6306 SK5	1	
37	052-109-14	Bearing 6306ZZC3	1	
38	122-245-13	O-Ring 71.4xd3.1 NBR	1	
39	058-000-36	Lead Wire Protection Plate d96xd224.5x1.6t PE	1	
40	055-003-45	Rotor + Bearing + Centrifugal Switch Set 1Set No.40.45.46.47.49.50	1	Price on req.

KTZ615-51

Kontroll-Nr. --

2019-05-22 V.01.02.2019

Pos.no	Item no.	Description	Quant.	UP
41	147-139-10	Impeller Key 7x7x28L SUS420 (EN X20Cr13) Stainless Steel	1	
42	056-009-62	Stator 400V-50Hz	1	Price on req.
43	121-504-10	Packing (Water Way, Upp.) KTZ411/611 NBR	1	
44	064-001-44	Motor Frame FC	1	Price on req.
45	140-080-14	Hex.Bolt M10x45 SUS304 (EN X5CrNi18-10)	4	
46	142-164-19	Spring Washer M10 SUS304	4	
47	140-032-37	Hex.Bolt M6x15 SWRM	4	
48	062-000-34	Bearing Collar MJA6135Z-C 15KW-2P SS	1	Price on req.
49	052-140-17	Bearing 6309ZZD2C3	1	
50	142-242-12	Bearing Washer AW09 SPCC	1	
51	141-074-18	Bearing Nut AN09 SS	1	
52	122-285-15	O-Ring 155xd3.1 NBR	1	
53	060-001-93	Bearing Housing FC	1	
54	140-269-19	Hex. Socket Cap Bolt M8x25 SUS304 (EN X5CrNi18-10) Stainless Steel	4	
55	143-070-23	Pan Screw M5x6 SWRM	2	
56	030-142-11	Oil Lifter H-30(A)(T) Resin	1	
57	143-070-10	Pan Screw M5x6 SWRM	6	
58	030-147-16	Seal Stopper HT-3035 SPCC	1	
59	025-000-73	Mechanical Seal H-30T(T) SIC	1	
60	122-285-15	O-Ring 155xd3.1 NBR	1	
61	121-503-19	Packing (Water Way, Low.) KTZ411/611 NBR	1	
62	029-333-17	Oil Casinq KTZ47.5/611 FC	1	
63	142-163-18	Spring Washer M8 SUS304	4	
64	140-055-10	Hex.Bolt M8x25 SUS304	4	
65	121-247-12	Packing d12.3xd18x2t PE	1	
66	035-113-18	Oil Plug M12x14 SUS304	1	
67	071-198-19	Shaft Sleeve d25xd35x17t SUS403 (EN X6Cr13) Stainless Steel	1	
68	020-001-06	Pump Casinq KTZ411/611 (FC)	1	
69	142-164-19	Spring Washer M10 SUS304	2	
70	140-449-15	Hex.Bolt M10x140 SUS304 (EN X5CrNi18-10) Stainless Steel	2	
71	122-360-15	O-Ring 46.5xd2.5 NBR	1	
72	026-238-12	Labyrinth Ring GHV/GHZ-7.5/11KW SUS304 (EN X5CrNi18-10) Stainless Steel	1	
73	040-107-28	Impeller Shim d25.2xd38x0.3t SUS304	1	
74	021-009-91	Impeller (50Hz) KTZ615-51 HiCrFC	1	
75	047-105-14	Impeller Thread Protect.Cover No.4(22) SPC	1	
76	141-009-38	Hex.Nut M20(H=12) SUS304	1	
77	141-034-16	Hex.Cap Nut M20 SUS304	1	
78	120-111-13	Packing (S.Cover) d221xd268x0.3t PE	1	
79	022-000-57	Suction Cover KTZ67.5/611 (FCD)	1	
80	142-128-24	Plain Washer M10 Kaltgewalztes Blech	3	
81	140-075-16	Hex.Bolt M10x25 SUS304	3	
82	142-128-24	Plain Washer M10 Kaltgewalztes Blech	3	
83	144-000-57	Stud Bolt M10x124(14/26) SUS403 (EN X6Cr13) Stainless Steel	3	
84	023-252-13	Strainer KTV-75/110 SPC	1	
85	049-133-20	Bottom Plate KRS-C3/A3 SPC	1	
86	142-128-24	Plain Washer M10 Kaltgewalztes Blech	3	
87	141-006-19	Hex.Nut M10 SUS304 (EN X5CrNi18-10)	3	
	173-000-86	Packing O-Ring Set (Marked by *)	1	
	##oilVG32	ml Turbine Oil ISO VG32	820	Price on req.

Exploded View

KTZ615-51